

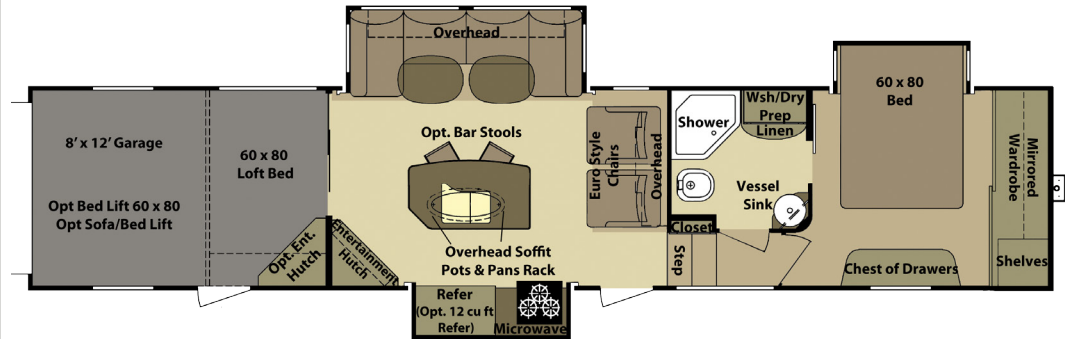

Rolling Thunder



H397RGR

2 Year Warranty

4-Point Leveling & Stabilizing System With Remote

Telescopic Sewer Hose Support and Storage

Dual Slide Out Trays With Up to 80Lbs of LP

100" Exterior Width

PVC Roof

SymaLite Exterior Sidewall Substrate

42" Deep Main Slide

Frameless Windows

15,000 BTU Dometic A/C w/"Quick Cool" Feature

(12% Better Air Flow than Competition)

Nitrogen Filled Radial Tires

LED Taillights

Rear Ramp Power Lift

4 Point Compression NORCO Slide Out System

Less Weight / More Room

Removable Exterior Ladders

R-38 Ceiling & R-38 Flooring Insulation

Full View Vented Entrance Door

Slam Latch Baggage Doors

Corian® Brand Counter Tops

Dinette Ladder Chair

Oversized Radiused Kitchen Island Tops

6 Person Extendable Table

Dove Tailed Drawers

Solid Wood Slide Out Fascia

Pull Out Waste Basket

Pull Out Pantry

Concealed Hinges

"Comfort Cloud" Mattress

Deeper Dresser Drawers

Residential Style Ceiling Fan

8 cu ft Refrigerator

50 Amp Service

Model Number/ Square Feet	397
GVWR	18000
UVW	13065
Hitch Weight	2415
Axle Weight	10650
GAWR - All Axles	18000
Gross NCC	4935
Ext. Length	42'
Ext Height (with A/C on roof)	155"
Ext. Width	100"
Water Heater	10 Gal Gas/Elec
Fresh Water (Gal)	85
Gray Water (Gal)	82
Waste (Gal)	41
LP Gas (Lbs)	80
Furnace (BTU's)	40,000
Tire Size	16"